

## Tomen y Bala

Roedd y domen o ddaear yn sylfaen i gastell pren canoloesol yn Nhomen y Bala. Mwy na thebyg cafodd ei adeiladu gan y Normaniaid, ond erbyn y 12fed ganrif hwn oedd llys cwmwd Tryweryn. Ym 1202, dinistriodd Llywelyn Fawr y castell yn ystod ymgyrch i ymestyn ei diriogaethau i'r dwyrain. Ym 1310, sefydlodd yr uchelwr Seisnig Roger Mortimer fwrdeistref (neu dref) yma. O ben ucha'r mwnt, gallwch weld cynllun y fwrdeistref o'r oesoedd canol. Mae gan y brif stryd ddwy lôn lai sy'n rhedeg yn gyfochrog â hi, a rhwng y rhain mae rhaniadau'r 'plotiau bwrdais' - stribynnau hir a chul lle'r oedd yr annedd ar hyd blaen y stryd yn wreiddiol gydag iardiau, tai allan a gardd y tu cefn iddo.

The earth mound of Tomen y Bala was the base of a medieval timber castle. It was probably constructed by the Normans, but by the 12th century was the llys (royal court) of the commote of Tryweryn. In 1202 Llywelyn the Great destroyed the castle during a campaign to extend his territories to the east. In 1310 English nobleman Roger Mortimer established a borough (town) here. From the top of the mound you can see the layout of the medieval borough. The main street has two smaller lanes running parallel to it, and between these are the divisions of the 'burgage plots' – long narrow strips where originally the dwelling was along the street front with yards, outbuildings and garden behind it.

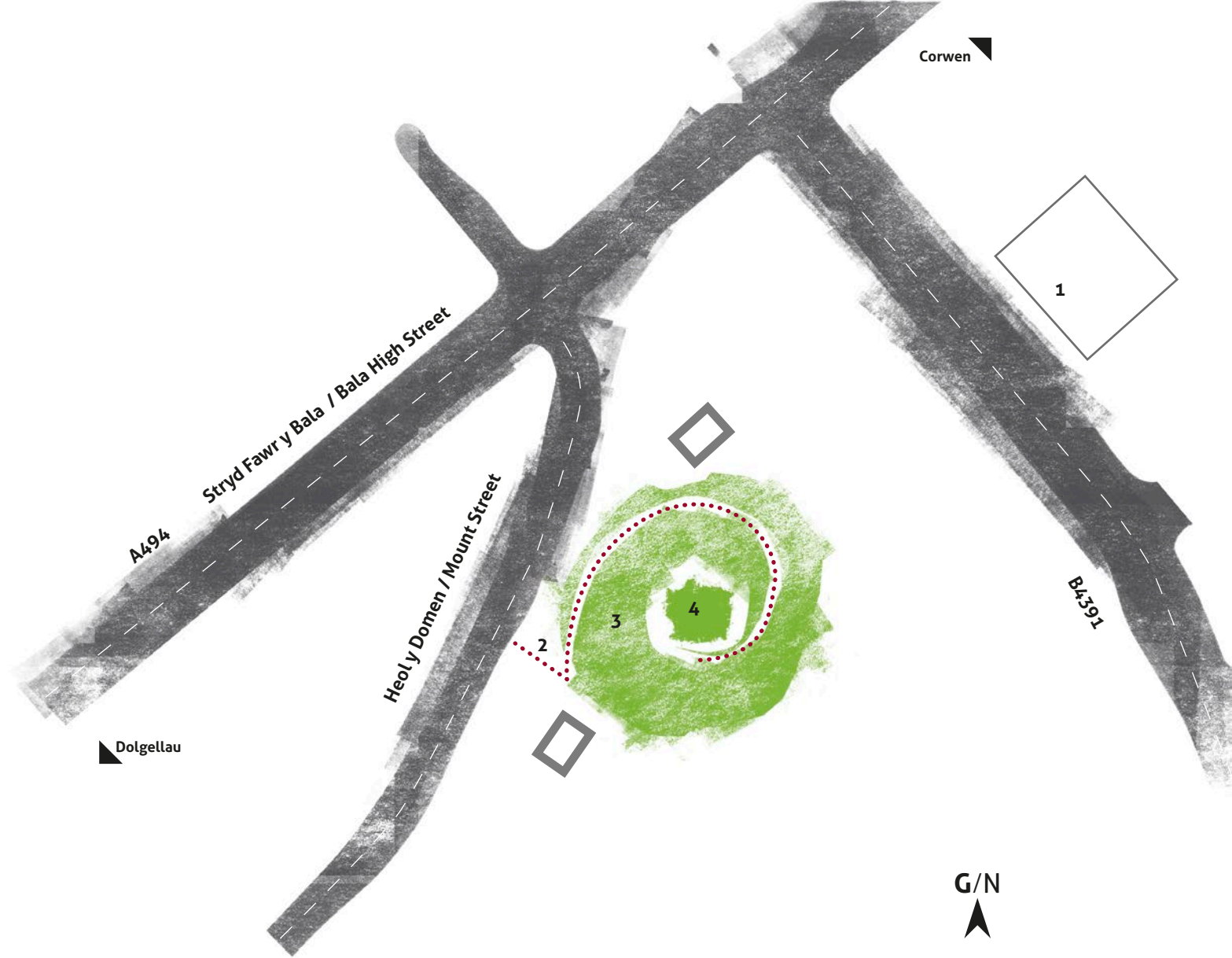

- 1 Maes parcio / Car park**
- 2 Gât y fynedfa / Entrance gate**
- 3 Tomen / Motte**
- 4 Safai tŵr o bren ar y copa gwastad ar un tro / A timber tower once stood on the flat summit**